

DETAILED PUMP STATION AREA
SCALE: 1" = 20'

GENERAL CONSTRUCTION NOTES:

1. AN AS-BUILT SURVEY IS REQUIRED.
2. WHILE WORKING WITHIN THE CONSTRUCTION LIMITS, THE CONTRACTOR SHALL BE RESPONSIBLE FOR CLEARING & GRUBBING AND THE REMOVAL OF ALL DEBRIS.
3. CONTRACTOR SHALL HAVE ALL EROSION CONTROL MEASURES IN PLACE PRIOR TO CONSTRUCTION.
4. CONTRACTOR TO NOTIFY UTILITY PROTECTION CENTER A MINIMUM OF 72 HOURS PRIOR TO CONSTRUCTION.
5. CONTRACTOR TO VERIFY ALL HORIZONTAL & VERTICAL LOCATIONS OF ALL EXISTING AND PROPOSED STRUCTURES PRIOR TO CONSTRUCTION.
6. CONTRACTOR TO NOTIFY ENGINEER OF ANY CONFLICTS IN THE PLANS PRIOR TO AND DURING CONSTRUCTION. FAILURE TO NOTIFY ENGINEER WILL RESULT IN CONTRACTOR RESPONSIBILITY TO REPAIR AT OWN EXPENSE.
7. CONTRACTOR RESPONSIBLE FOR ALL DAMAGED UTILITIES DURING CONSTRUCTION.
8. PEDESTRIAN AND LOCAL TRAFFIC SHALL BE MAINTAINED AT ALL TIMES DURING CONSTRUCTION. SAFETY DEVICES AND FLAGGERS WILL BE PROVIDED AT CONTRACTOR EXPENSE.
9. CONTRACTOR TO PROVIDE ALL CONSTRUCTION STAKING.
10. ALL WORK SHALL BE IN ACCORDANCE WITH CITY OF VALDOSTA STANDARDS AND SPECIFICATIONS.
11. ALL EXTENSIONS AND ADDITIONS TO THE SYSTEM SHALL BE PERFORMED BY A GEORGIA LICENSED UTILITY CONTRACTOR.
12. A MINIMUM OF 18" OF VERTICAL AND 10' OF HORIZONTAL SEPARATION SHALL BE MAINTAINED BETWEEN ALL UTILITIES.
13. ALL T'S AND BENDS SHALL BE DUCTILE IRON.

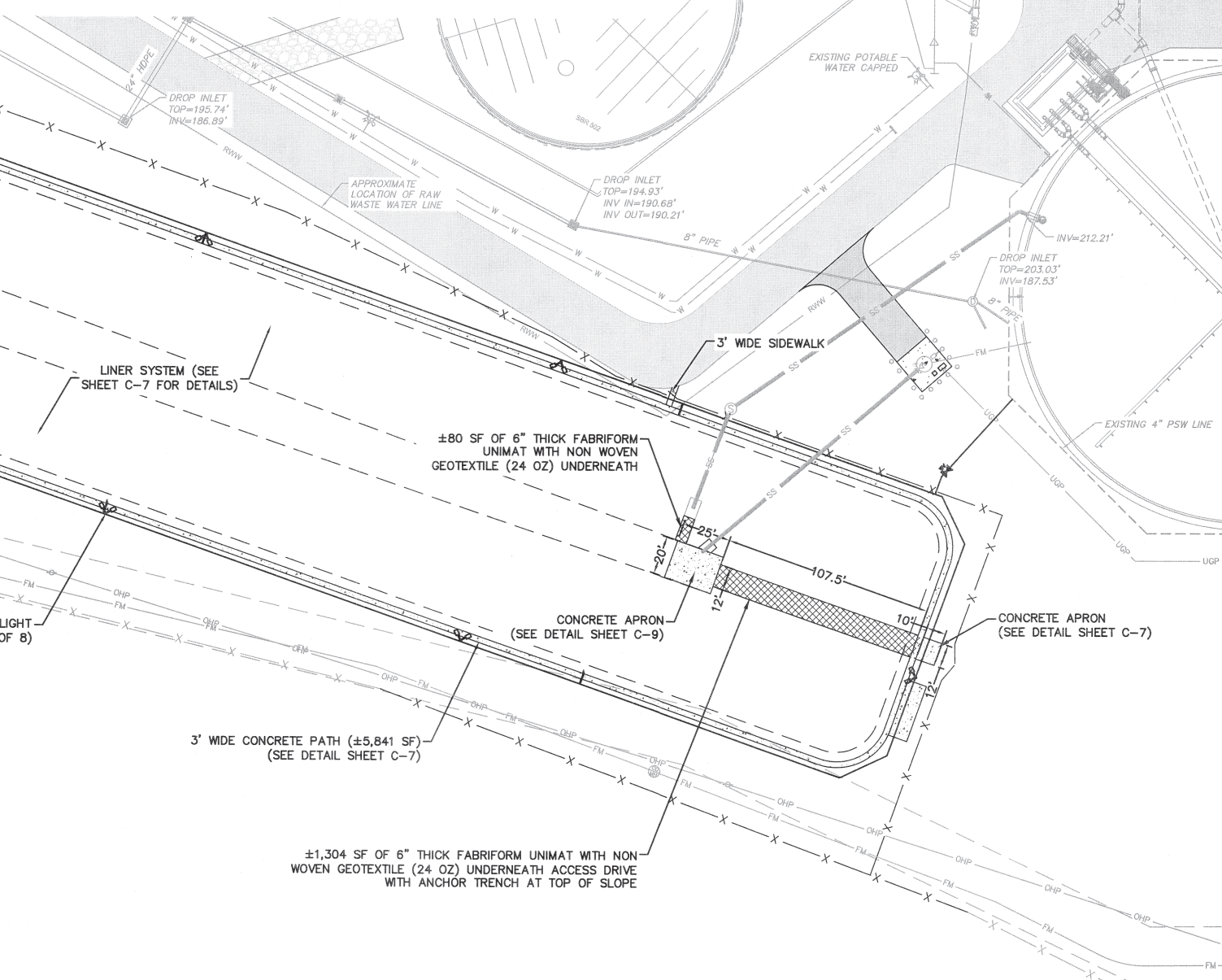

LEA
CIVIL • AGRICULTURAL • ENVIRONMENTAL

GA CORP# 0419099
FL CORP# F0400002135
P.O. Box 2830
3998 Inner Perimeter Road
Valdosta, GA 31604
Telephone: 229-253-0800
Fax: 229-253-1842
E-mail: lea@lea-pc.com

CITY OF VALDOSTA
WITHLACOCHEE WWTP
SECONDARY
EQUALIZATION BASIN

LAND LOT 63 OF THE 11TH LAND DISTRICT
LOWNDES COUNTY - STATE OF GEORGIA

REVISIONS

DATE	DESCRIPTION

GRAPHIC SCALE

0 20 40 80

(IN FEET)
1 INCH = 40 FEET

N
O
R
T
H

SCALE: 1"=40'

DESIGNED BY: MCM

CHECKED BY: JSL

SUBMITTAL DATE: 08/30/19

JOB NO. 0026-33

THESE DRAWINGS ARE THE PROPERTY OF THE ENGINEER AND MAY NOT BE REPRODUCED OR REUSED WITHOUT PERMISSION AND CREDIT. © LEA 2019

GEORGIA
REGISTERED
No. 34187
MICHAEL CLAYTON MILKMAN
ENGINEER
5/30/19

GSWCC LEVEL II CERT. #49262

SITE AND UTILITY PLAN

C-3

3 OF 16 SHEETS

S:\0026-33 (City of Valdosta, Secondary ED Basin)\Withlacoochee Secondary EQ Basin.dwg 9/2/2019 1:58 PM