

GEORGIA UNIFORM CODING SYSTEM

FOR SOIL EROSION AND SEDIMENT CONTROL PRACTICES
GEORGIA SOIL AND WATER CONSERVATION COMMISSION

STRUCTURAL PRACTICES

| CODE | PRACTICE | DETAIL | MAP SYMBOL | DESCRIPTION |
|------|------------------------------|--------|------------|--|
| Cd | CHECKDAM | | | A small temporary barrier or dam constructed across a swale, drainage ditch or area of concentrated flow. |
| Ch | CHANNEL STABILIZATION | | | Improving, constructing or stabilizing an open channel, existing stream, or ditch. |
| Co | CONSTRUCTION EXIT | | | A crushed stone pad located at the construction site exit to provide a place for removing mud from tires thereby protecting public streets. |
| Sd1 | SEDIMENT BARRIER | | | A barrier to prevent sediment from leaving the construction site. It may be sandbags, bales of straw or hay, brush, logs and poles, gravel, or a silt fence. |
| Sd3 | TEMPORARY SEDIMENT BASIN | | | A basin created by excavation or a dam across a waterway. The surface water runoff is temporarily stored allowing the bulk of the sediment to drop out. |
| Sk | FLOATING SURFACE SKIMMER | | | A buoyant device that releases/draws water from the surface of sediment ponds, traps, or basins at a controlled rate of flow. |
| St | STORMDRAIN OUTLET PROTECTION | | | A paved or short section of riprap channel at the outlet of a storm drain system preventing erosion from the concentrated runoff. |

VEGETATIVE PRACTICES

| CODE | PRACTICE | DETAIL | MAP SYMBOL | DESCRIPTION |
|------|---|--------|------------|---|
| Ds1 | DISTURBED AREA STABILIZATION (WITH MULCHING ONLY) | | | Establishing temporary protection for disturbed areas where seedlings may not have a suitable growing season to produce an erosion retarding cover. |
| Ds2 | DISTURBED AREA STABILIZATION (WITH TEMP SEEDING) | | | Establishing a temporary vegetative cover with fast growing seedlings on disturbed areas. |
| Ds3 | DISTURBED AREA STABILIZATION (WITH PERM SEEDING) | | | Establishing a permanent vegetative cover such as trees, shrubs, vines, grasses, or legumes on disturbed areas. |
| Ds4 | DISTURBED AREA STABILIZATION (SODDING) | | | A permanent vegetative cover using sods on highly erodible or critically eroded lands. |
| Du | DUST CONTROL ON DISTURBED AREAS | | | Controlling surface and air movement of dust on construction site, roadways and similar sites. |

Co CRUSHED STONE CONSTRUCTION EXIT

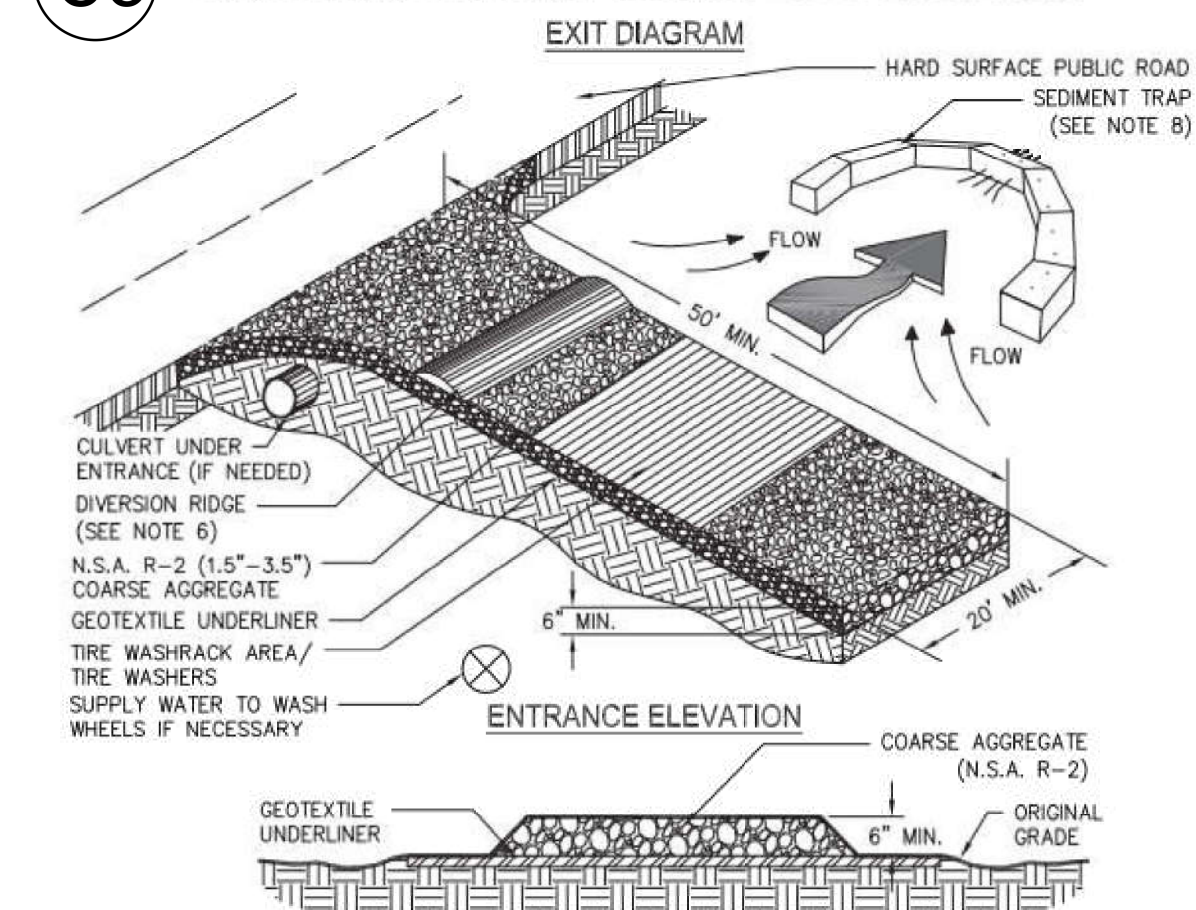

- NOTES:
1. AVOID LOCATING ON STEEP SLOPES OR AT CURVES ON PUBLIC ROADS.
 2. REMOVE ALL VEGETATION AND OTHER UNSUITABLE MATERIAL FROM THE FOUNDATION AREA, GRADE, AND CROWN FOR POSITIVE DRAINAGE.
 3. AGGREGATE SIZE SHALL BE IN ACCORDANCE WITH NATIONAL STONE ASSOCIATION R-2 (1.5"-3.5" STONE).
 4. GRAVEL PAD SHALL HAVE A MINIMUM THICKNESS OF 6".
 5. PAD WIDTH SHALL BE EQUAL FULL WIDTH AT ALL POINTS OF VEHICULAR EGRESS, BUT NO LESS THAN 20'.
 6. A DIVERSION RIDGE SHOULD BE CONSTRUCTED WHEN GRADE TOWARD PAVED AREA IS GREATER THAN 2%.
 7. INSTALL PIPE UNDER THE ENTRANCE IF NEEDED TO MAINTAIN DRAINAGE DITCHES.
 8. WHEN WASHING IS REQUIRED, IT SHOULD BE DONE ON AN AREA STABILIZED WITH CRUSHED STONE THAT DRAINS INTO AN APPROVED SEDIMENT TRAP OR SEDIMENT BASIN (DIVERGENT ALL SURFACE RUNOFF AND DRAINAGE FROM THE ENTRANCE TO A SEDIMENT CONTROL DEVICE).
 9. WASHRACKS AND/OR TIRE WASHERS MAY BE REQUIRED DEPENDING ON SCALE AND CIRCUMSTANCE. IF NECESSARY, WASHRACK DESIGN MAY CONSIST OF ANY MATERIAL SUITABLE FOR TRUCK TRAFFIC THAT REMOVE MUD AND DIRT.
 10. MAINTAIN AREA IN A WAY THAT PREVENTS TRACKING AND/OR FLOW OF MUD ONTO PUBLIC RIGHTS-OF-WAYS. THIS MAY REQUIRE TOP DRESSING, REPAIR AND/OR CLEANOUT OF ANY MEASURES USED TO TRAP SEDIMENT.

Sd1-S SILT FENCE - TYPE NON-SENSITIVE

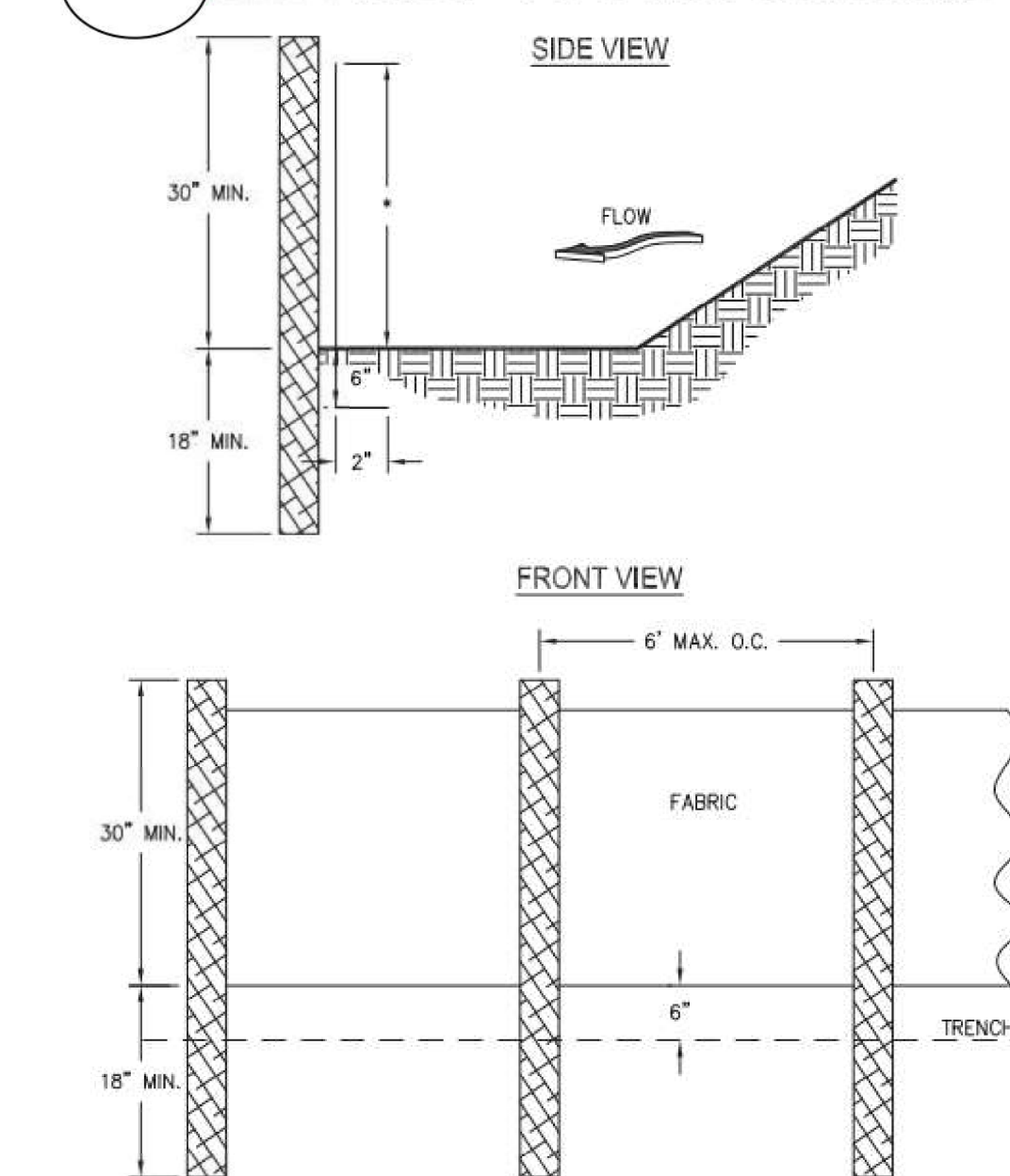

- NOTES:
1. USE STEEL OR WOOD POSTS OR AS SPECIFIED BY THE EROSION, SEDIMENTATION, AND POLLUTION CONTROL PLAN.
 2. HEIGHT (*) IS TO BE SHOWN ON THE EROSION, SEDIMENTATION, AND POLLUTION CONTROL PLAN.

FIGURE 7A: EROSION CONTROL DETAILS

TWIN PINES MINERALS
ST. GEORGE, CHARLTON COUNTY, GEORGIA

DRAWN BY: DEK
CHECKED BY: SGR
DRAWING DATE: 6/18/2020
REVISION DATE: N/A
TTL JOB NO.: 000180200804.00
APPROX. SCALE:

FIGURE 7B: CONSTRUCTION ENTRY/EXIT & SILT FENCE DETAILS

TWIN PINES MINERALS
ST. GEORGE, CHARLTON COUNTY, GEORGIA

DRAWN BY: DEK
CHECKED BY: SGR
DRAWING DATE: 6/18/2020
REVISION DATE: N/A
TTL JOB NO.: 000180200804.00
APPROX. SCALE:

Sr-C CONFIGURATION OF TEMPORARY CULVERT CROSSINGS

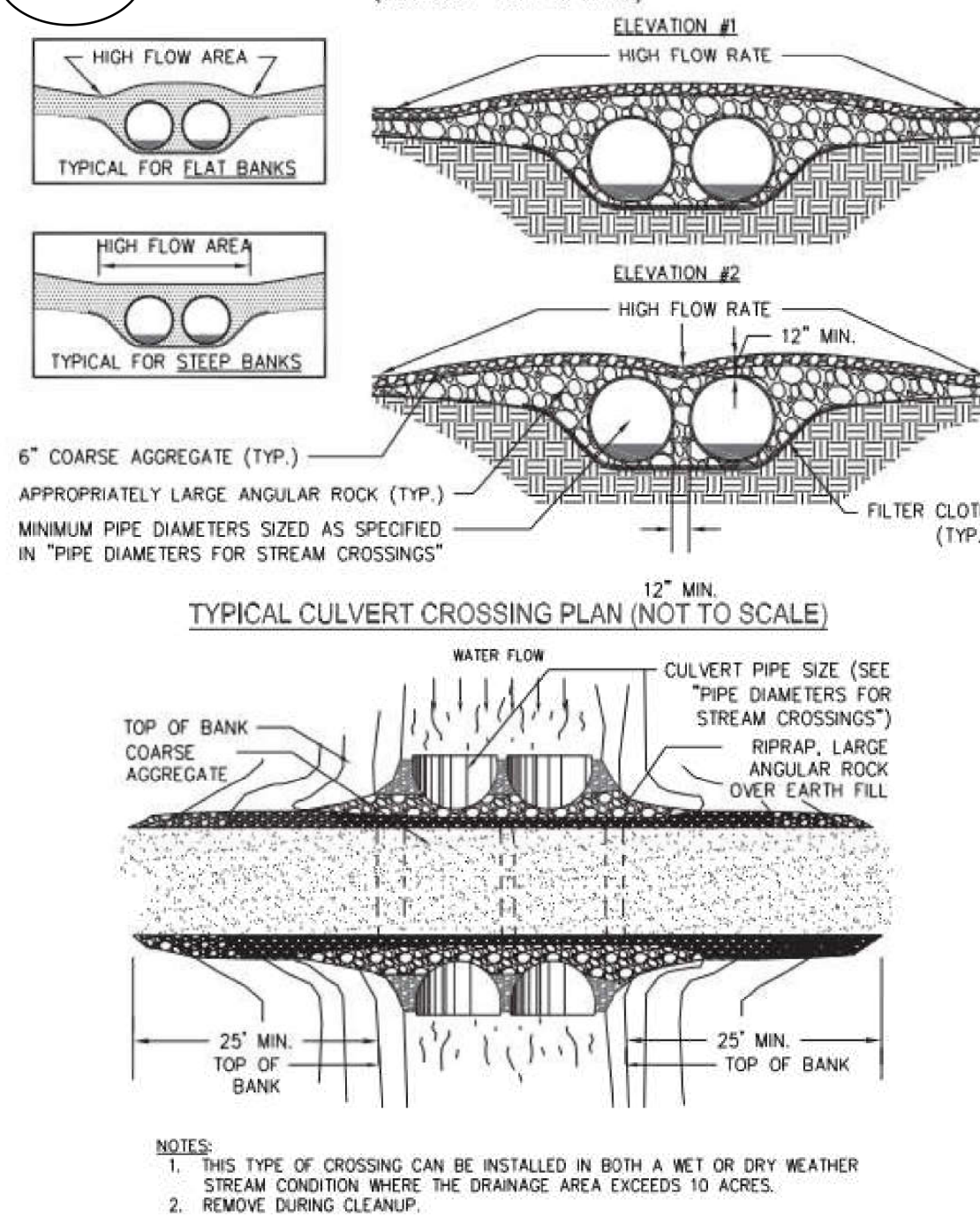

- NOTES:
1. THIS TYPE OF CROSSING CAN BE INSTALLED IN BOTH A WET OR DRY WEATHER STREAM CONDITION WHERE THE DRAINAGE AREA EXCEEDS 10 ACRES.
 2. REMOVE DURING CLEANUP.

Wt WATERWAY WITH STONE CENTER DRAIN AND V-SECTION SHAPED BY MOTOR GRADER

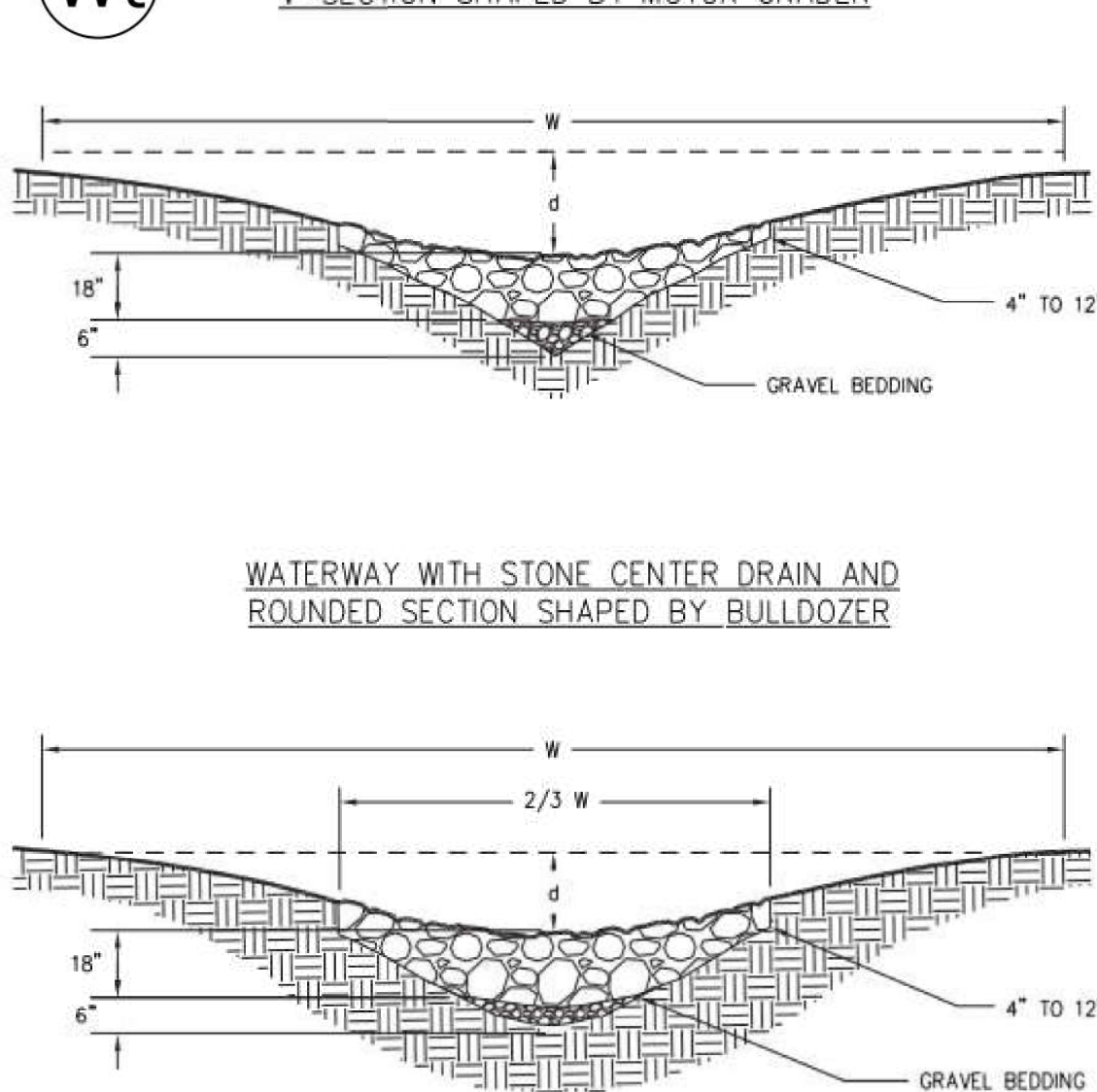

St RIPRAP OUTLET PROTECTION

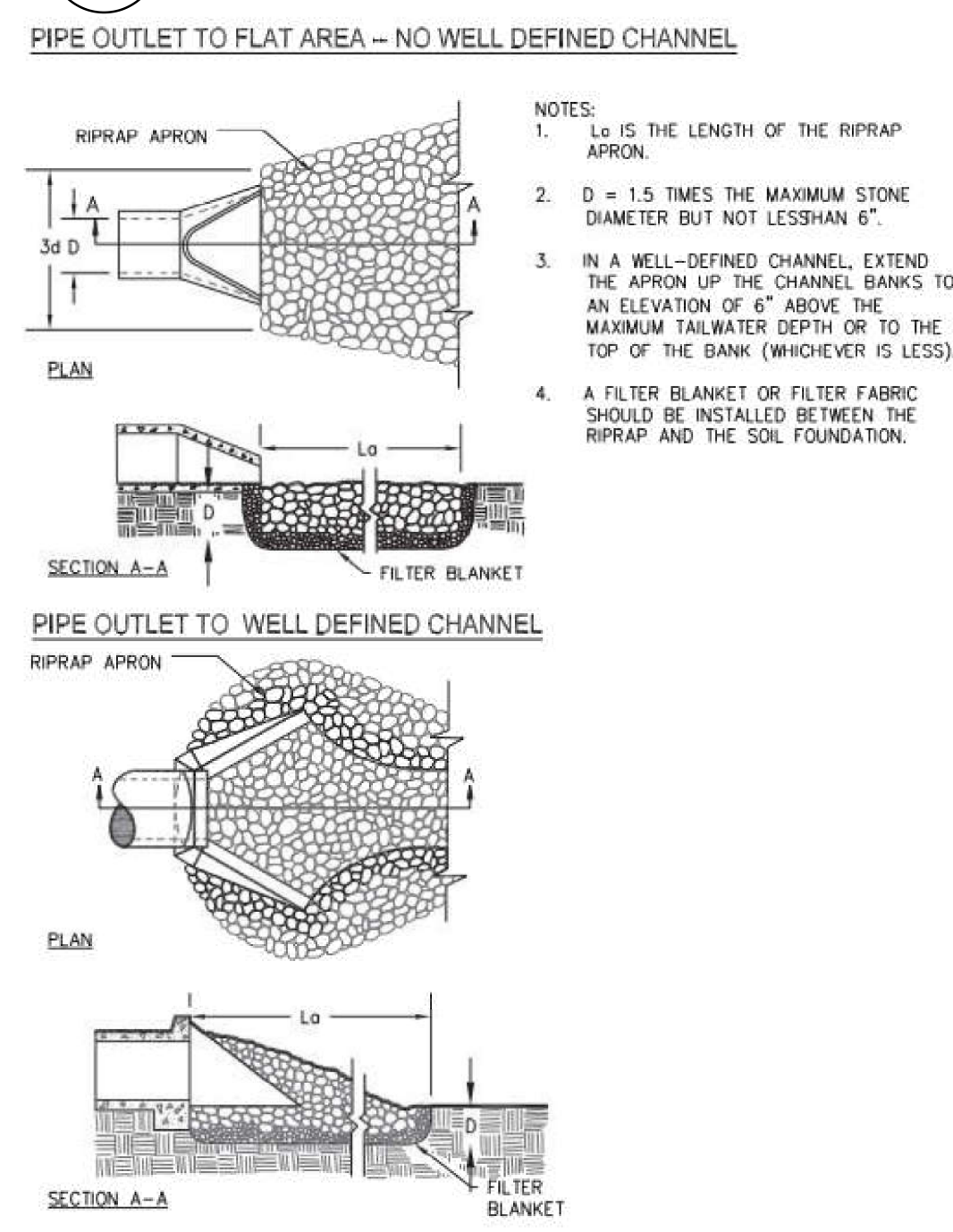

- NOTES:
1. Lo IS THE LENGTH OF THE RIPRAP APRON.
 2. D = 1.5 TIMES THE MAXIMUM STONE DIAMETER BUT NOT LESS THAN 6".
 3. IN A WELL-DEFINED CHANNEL, EXTEND THE APRON UP THE CHANNEL BANKS TO AN ELEVATION OF 6" ABOVE THE MAXIMUM TAILWATER DEPTH OR TO THE TOP OF THE BANK (WHICHEVER IS LESS).
 4. A FILTER BLANKET OR FILTER FABRIC SHOULD BE INSTALLED BETWEEN THE RIPRAP AND THE SOIL FOUNDATION.

EROSION CONTROL NOTES:

1. THE ESCAPE OF SEDIMENT FROM THE SITE SHALL BE PREVENTED BY THE INSTALLATION OF EROSION AND SEDIMENT CONTROL MEASURES AND PRACTICES PRIOR, OR CONCURRENT WITH LAND DISTURBING ACTIVITIES.
2. EROSION CONTROL MEASURES WILL BE MAINTAINED AT ALL TIMES. IF FULL IMPLEMENTATION OF THE APPROVED PLAN DOES NOT PROVIDE FOR EFFECTIVE EROSION CONTROL, ADDITIONAL EROSION AND SEDIMENT CONTROL MEASURES SHALL BE IMPLEMENTED TO CONTROL OR TREAT THE SEDIMENT SOURCE.
3. ANY DISTURBED AREA LEFT EXPOSED FOR PERIOD GREATER THAN 14 DAYS SHALL BE STABILIZED WITH MULCH OR TEMPORARY SEEDING.
4. ALL EROSION AND SEDIMENT CONTROL MEASURES SHALL CONFORM WITH THE GUIDELINES OF THE "MANUAL FOR EROSION AND SEDIMENT CONTROL."
5. FEDERAL EMERGENCY MANAGEMENT AGENCY (FEMA) FLOOD INSURANCE RATE MAP (FIRM) PANEL _____ DATED _____ INDICATES NO SPECIAL FLOOD HAZARD AREAS WITHIN THE PROJECT AREA.
6. EROSION CONTROL MEASURES SHALL BE INSTALLED PRIOR TO ANY OTHER CONSTRUCTION/MINING ACTIVITY AND MAINTAINED UNTIL PERMANENT GROUND COVER IS ESTABLISHED.
7. DURING CONSTRUCTION AND MINING ACTIVITIES, THE OPERATOR SHALL MAINTAIN CAREFUL SCHEDULING AND PERFORMANCE TO ENSURE THAT LAND STRIPPED OF ITS NATURAL GROUND COVER IS EXPOSED ONLY IN SMALL QUANTITIES, AND PROTECTION IS ESTABLISHED.
8. SEDIMENT AND EROSION CONTROL MEASURES MUST BE CHECKED AFTER EACH RAIN EVENT. EACH DEVICE IS TO BE MAINTAINED OR REPLACED IF SEDIMENT ACCUMULATION HAS REACHED HALF THE CAPACITY OF THE DEVICE. ADDITIONAL DEVICES MUST BE INSTALLED IF NEW CHANNELS HAVE DEVELOPED.
9. OPERATOR SHALL INSPECT EROSION CONTROL MEASURES AT THE END OF EACH WORKING DAY TO ENSURE PROPER FUNCTIONING.

[OPERATOR'S NAME]
[MINE NAME]
[PERMIT NUMBER]
[CONTACT INFORMATION]

IDENTIFICATION SIGN (Typical)

FIGURE 7C: CULVERT CROSSING & WATERWAY DETAILS

TWIN PINES MINERALS
ST. GEORGE, CHARLTON COUNTY, GEORGIA

DRAWN BY: DEK
CHECKED BY: SGR
DRAWING DATE: 6/18/2020
REVISION DATE: N/A
TTL JOB NO.: 000180200804.00
APPROX. SCALE:

FIGURE 7D: RIP-RAP DETAILS & EROSIONAL CONTROL NOTES

TWIN PINES MINERALS
ST. GEORGE, CHARLTON COUNTY, GEORGIA

DRAWN BY: DEK
CHECKED BY: SGR
DRAWING DATE: 6/18/2020
REVISION DATE: N/A
TTL JOB NO.: 000180200804.00
APPROX. SCALE: