



GA CORP# 0419099  
 FL CORP# F04000002195  
 3538 Inver Penner Road  
 Valdosta, GA 31604  
 Telephone: 229-253-0900  
 Fax: 229-253-1842  
 E-mail: [lea@lea-ge.com](mailto:lea@lea-ge.com)

**OLD CLAYVILLE ROAD WIDENING**  
**PI#0016285**  
 LAND LOT 64 & 29 OF THE  
 CITY OF VALDOSTA  
 LOWMEDES COUNTY  
 STATE OF GEORGIA

REVISIONS	DATE	DESCRIPTION

SCALE:	DESIGNED BY:	CHECKED BY:	SUBMITTAL DATE:	JOB NO.
1"=20'	DEA	MCM	03-24-23	002640

GRAPHIC SCALE  
 1 INCH = 20 FEET (HORIZ)  
 1 INCH = 4 FEET (VERT)



GSWCC LEVEL II CERT. #49262

**15-003**  
 MAINLINE PROFILE  
 (STA 10+50 - 15+50)

5:\002640.dwg (City of Valdosta, Old Clayville Road Widening)\002640-production\15-003.dwg 9/7/2023 3:08 PM

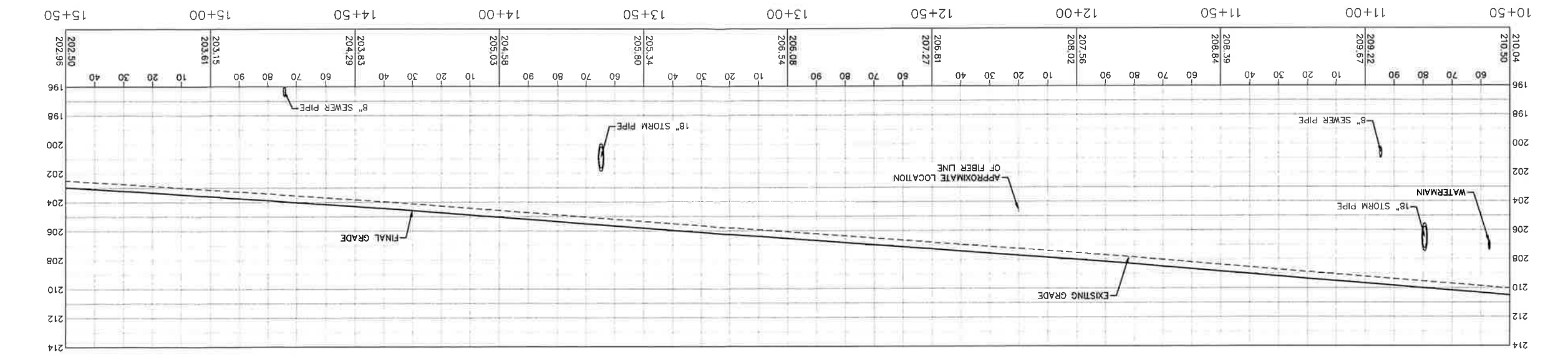
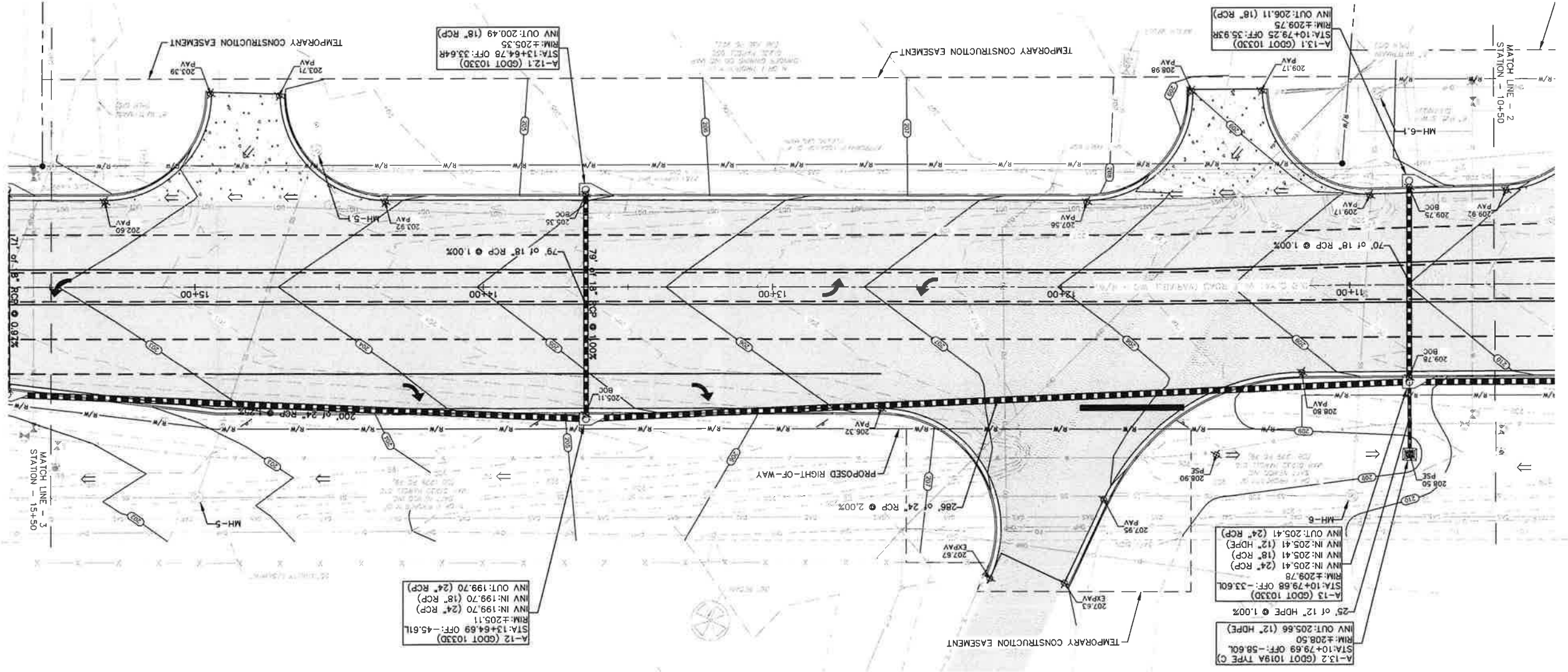

A-12 (GDOT 1033D)  
 STA: 13+64.69 OFF: -45.61L  
 INV IN: 199.70 (18" RCP)  
 INV IN: 199.70 (24" RCP)  
 INV OUT: 199.70 (24" RCP)

A-13.2 (GDOT 1019A TYPE C)  
 STA: 10+79.89 OFF: -58.60L  
 RIM: ±208.50  
 INV OUT: 205.66 (12" HDPE)  
 A-13 (GDOT 1033D)  
 STA: 10+79.88 OFF: -33.60L  
 RIM: ±209.78  
 INV IN: 205.41 (24" RCP)  
 INV IN: 205.41 (18" RCP)  
 INV IN: 205.41 (12" HDPE)  
 INV OUT: 205.41 (24" RCP)

A-13.1 (GDOT 1033D)  
 STA: 10+79.25 OFF: 35.93R  
 RIM: ±209.75  
 INV OUT: 206.11 (18" RCP)

A-12.1 (GDOT 1033D)  
 STA: 13+64.78 OFF: 33.64R  
 RIM: ±205.35  
 INV OUT: 200.49 (18" RCP)