



GA CORP# 0419099
 FL CORP# F0400002135
 P.O. Box 2830
 3998 Hwy. Pentamer Road
 Valdosta, GA 31604
 Telephone: 229-253-0900
 Fax: 229-253-1842
 E-mail: lee@lea-ge.com

**OLD
 CLAYVILLE
 ROAD
 WIDENING
 PI#0016285**

LAND LOT 64 & 29 OF THE
 11TH LAND DISTRICT
 CITY OF VALDOSTA
 LOWMEDES COUNTY
 STATE OF GEORGIA

REVISIONS

| DATE | DESCRIPTION |
|------|-------------|
| | |
| | |
| | |

GRAPHIC SCALE
 (IN FEET)
 1 INCH = 20 FEET (HOR)
 1 INCH = 4 FEET (VERT)



SCALE: 1"=20'

DESIGNED BY: DEA
 CHECKED BY: MCM
 SUBMITTAL DATE: 03-24-23
 JOB NO. 0026-40

THESE DRAWINGS ARE THE PROPERTY OF THE ENGINEER AND MAY NOT BE REPRODUCED OR COPIED WITHOUT PERMISSION AND CREDIT TO LEA, P.C. 2023



GSWCC LEVEL II CERT. #49262

**MAINLINE PROFILE
 (STA 35+50 - 40+50)**

15-008

21 OF 74 SHEETS

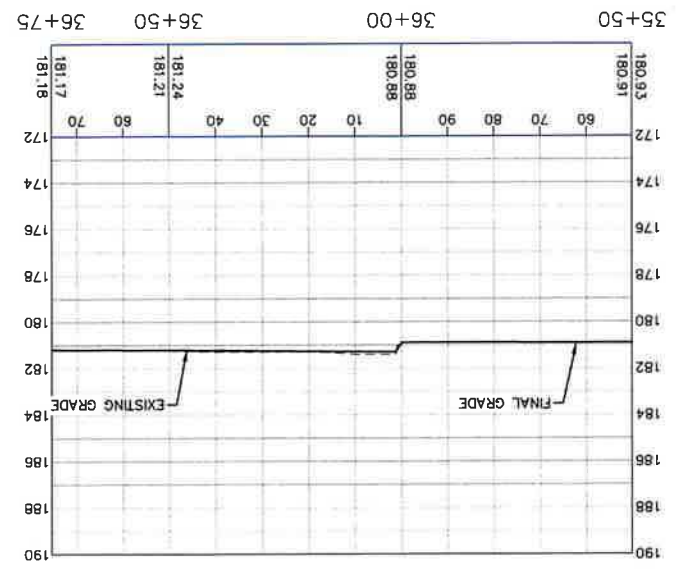
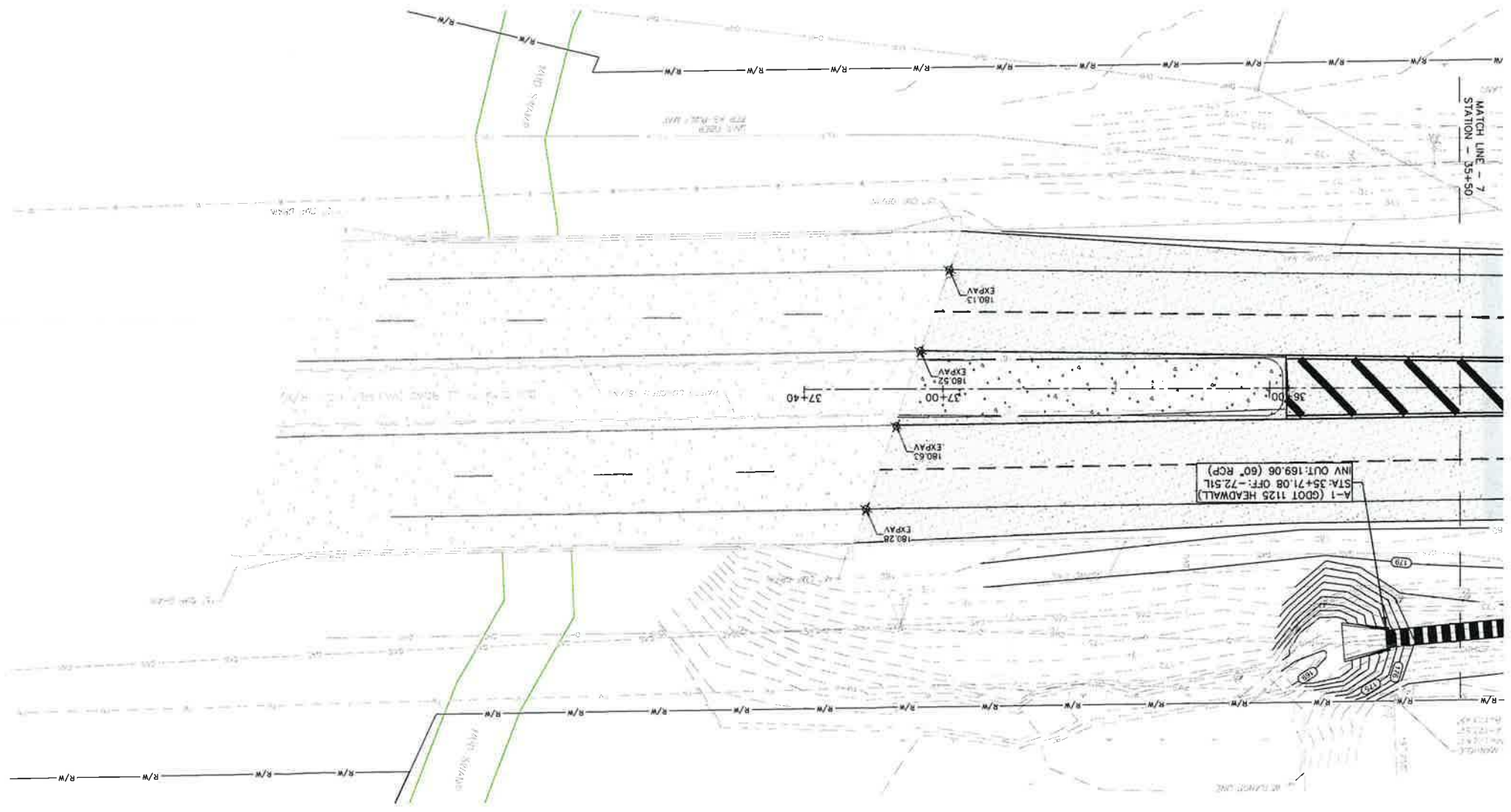

A-1 (GDOT 1125 HEADWALL)
 STA: 35+71.08 OFF: -72.51L
 INV OUT: 169.08 (60" RCP)

MATCH LINE - 7
 STATION - 35+50