

Boring ID	Depth to the Top of the Hawthorn Group (feet below ground surface)	Elevation of the Top of the Hawthorn Group (feet above mean sea level)
EB08	121.00	52.68
OWB EB	122.00	50.69
UD25	100.00	65.49
UD238	112.50	55.81
PB07	111.00	62.50
PB09	110.00	63.25

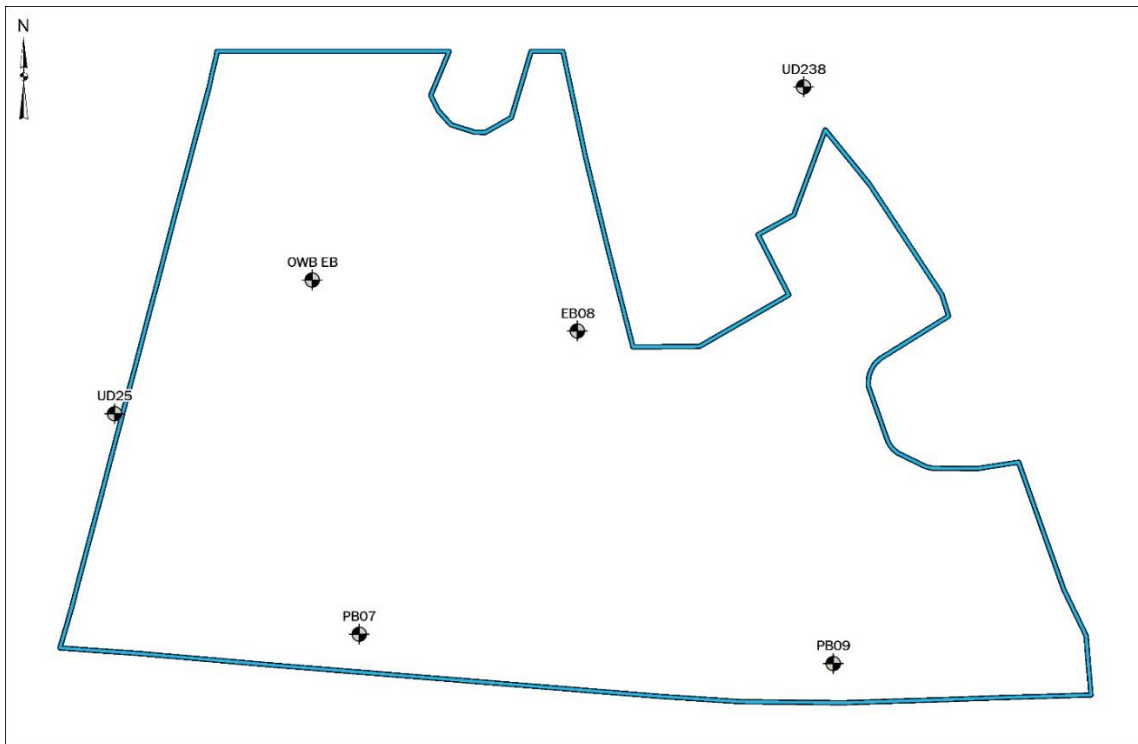

- h. In Section 3.1.2., 2nd paragraph, give the estimated depths and screen intervals of the shallow and deep piezometers. In the 3rd paragraph – Fig 11 shows the cone of depression to be about 3600 ft long, not 2000.*

Response: The estimated depths of the screen intervals of the shallow (10-50 feet bgs) and deep (70-80 feet bgs) piezometers are provided on Sheet 10 Section 1.1.2 (a) and (b) of the MLUP. The sentence and figure in the referenced “3rd paragraph - Fig 11” have been removed.

- i. In Section 3.1.2.b), 1st paragraph, give a brief explanation of why the depths of 50 and 80 feet were chosen.*

Response: Done –Sheet 10 Section 1.1.2 (a) - Twenty-four (24) piezometers will be installed within the footprint of the mine. Eighteen (18) piezometers will be installed to depths of about 50 feet bgs and used to monitor water quality across the maximum vertical extent of the proposed mine. Six (6) piezometers will be installed to depths of