

NOTES:

1. ALL NOTES REFERRING TO "SECTION (#) OF ORDINANCE" ARE IN REFERENCE TO THE ZONING ORDINANCE OF BROOKS COUNTY AS AMENDED ON 1/1/2021 TO INCLUDE SOLAR
2. ALL ITEMS IN PLAN SUBJECT TO MINOR MODIFICATIONS (TO BE APPROVED BY COUNTY) AS A RESULT OF FEEDBACK FROM REGULATORY AGENCIES
3. NO LIGHTING ON SITE. COMPLIES WITH SECTION 9-8.6 (D) OF ORDINANCE
4. A GROUND-MOUNTED SES SHALL BE MAINTAINED IN GOOD WORKING ORDER AS PER SECTION 9-8.6 (F) OF ORDINANCE
5. AS PER SECTION 9-8.6 (H) OF ORDINANCE, GROUND-MOUNTED COMPONENTS ON CORNER LOTS SHALL NOT BE LOCATED CLOSER TO THE SIDE PROPERTY LINE ALONG A PUBLIC STREET THAN THE PERMITTED DISTANCE FOR THE PRINCIPAL BUILDING ON THE LOT
6. AS PER SECTION 9-8.9 (D) OF ORDINANCE, (a) THE LARGE SCALE SES SHALL BE DESIGNED BY A LICENSED ENGINEER, (b) A LICENSED AND CERTIFIED ELECTRICIAN SHALL INSTALL AND CONSTRUCT A LARGE SCALE SES AND A THIRD PARTY LICENSED AND CERTIFIED ELECTRICIAN SHALL INSPECT THE ELECTRICAL CONNECTIONS PRIOR TO OPERATION, AND (c) THE THE APPROPRIATE PUBLIC UTILITY SHALL INSPECT ANY OPERATING CONNECTION TO THE GRID
7. AS PER SECTION 9-8.10 (D) OF ORDINANCE, CONSTRUCTION AND OPERATION OF THE SES WILL COMPLY WITH ALL APPLICABLE FEDERAL, STATE, AND LOCAL LAWS AND REGULATIONS, INCLUDING THE REQUIREMENTS OF THE UNDERLYING ZONING ORDINANCE, UNLESS OTHERWISE EXPRESSLY STATED IN THIS ORDINANCE. BEFORE OPERATION, A FIRE SAFETY AND EVACUATION PLAN WILL BE FILED WITH THE APPROPRIATE FIRE CODE AND EMERGENCY MANAGEMENT OFFICIALS, AND WILL BE AVAILABLE IN WORKPLACE FOR REFERENCE AND REVIEW BY EMPLOYEES WORKING ON THE PREMISES. GENERAL LIABILITY INSURANCE WILL BE MAINTAINED THROUGHOUT THE LIFE OF THE SES PROJECT. IF THE UNDERLYING ZONING ORDINANCE DOES NOT SPECIFY THE COVERAGE, SUCH GENERAL LIABILITY INSURANCE WILL INCLUDE, BUT NOT BE LIMITED TO, COMMERCIAL FORM, PREMISES-OPERATIONS, PRODUCTS/COMPLETED OPERATIONS HAZARD, CONTRACTUAL INSURANCE, BROAD FORM PROPERTY DAMAGE, AND PERSONAL INJURY.
8. GROUND MOUNTED COMPONENTS SHALL NOT BE LOCATED IN THE REQUIRED SETBACKS OF THE UNDERLYING ZONING DISTRICT, AS PER SECTION 9-8.6 (A) OF ORDINANCE
9. THE LARGE SCALE SES SHALL BE LOCATED NO CLOSER THAN THE LESSER OF (a) 50 FT FROM ANY PROPERTY LINE OR INGRESS/EGRESS EASEMENT, OR (b) THE SETBACK STANDARDS FOR THE UNDERLYING ZONING DISTRICT, IF ANY. THE LARGE SCALE SES SHALL BE LOCATED NO CLOSER THAN THE LESSER OF (a) 100 FT FROM ANY PUBLIC RIGHT OF WAY, OR (b) THE SETBACK STANDARDS FOR THE UNDERLYING ZONING DISTRICT, IF ANY. THE LARGE SCALE SES SHALL BE LOCATED NO CLOSER THAN 500 FT FROM ANY RESIDENTIAL DWELLING UNIT TO COMPLY WITH SECTION 9-8.9 (B) OF ORDINANCE
10. DECOMMISSIONING (SEE PAGES APP-101, APP-102)
11. WARNING SIGNAGE (SEE BELOW DETAIL)
12. SLD (SEE PAGES APP-103, APP-104)
13. COUNTY ZONING (SEE PAGE APP-105)
14. PERIMETER FENCE (SEE BELOW DETAIL)
15. ACCESS ROADS (SEE BELOW DETAIL)
16. WETLANDS AND FLOODPLAIN DATA SOURCE (SEE PAGE APP-107)
17. FAA DOCUMENTS (SEE PAGE APP-108)
18. DEMOLITION AND REMOVAL OF ANY BUILDING OR STRUCTURE SHALL BE CONDUCTED IN ACCORDANCE WITH ALL APPLICABLE LAWS AND REGULATIONS.



130 ROBERTS STREET  
ASHEVILLE, NC 28801

SITE PLAN IS COMPLIANT WITH  
SECTION 9-8.10 (D) OF ORDINANCE

**WARNING**

ARC FLASH AND SHOCK HAZARD PRESENT  
APPROPRIATE PPE REQUIRED

---

PROJECT OWNER: PINE GATE RENEWABLES, LLC

---

EMERGENCY CONTACT INFO

PROJECT MANAGER: MIKALA NEWSOM

PHONE: 828-232-6471

NOTE 11 DETAIL

TO COMPLY WITH SECTION 9-8.9 (C) OF ORDINANCE, THE PROJECT:

- 1) SHALL HAVE WARNING SIGNS (a) DISPLAYING THE DANGERS ASSOCIATED WITH A LARGE SCALE SES, (b) IDENTIFYING THE OWNER OR OPERATOR OF THE LARGE SCALE SES, AND (c) PROVIDE A 24-HOUR EMERGENCY CONTACT PHONE NUMBER ABOUT THE LARGE SCALE SES
- 2) MAY HAVE SIGNS THAT CONTAIN EDUCATIONAL INFORMATION ABOUT THE LARGE SCALE SES
- 3) SHALL NOT HAVE SIGNS USED FOR DISPLAYING ANY ADVERTISEMENT EXCEPT FOR REASONABLE IDENTIFICATION OF THE MANUFACTURER OR OPERATOR OF THE LARGE SCALE SES

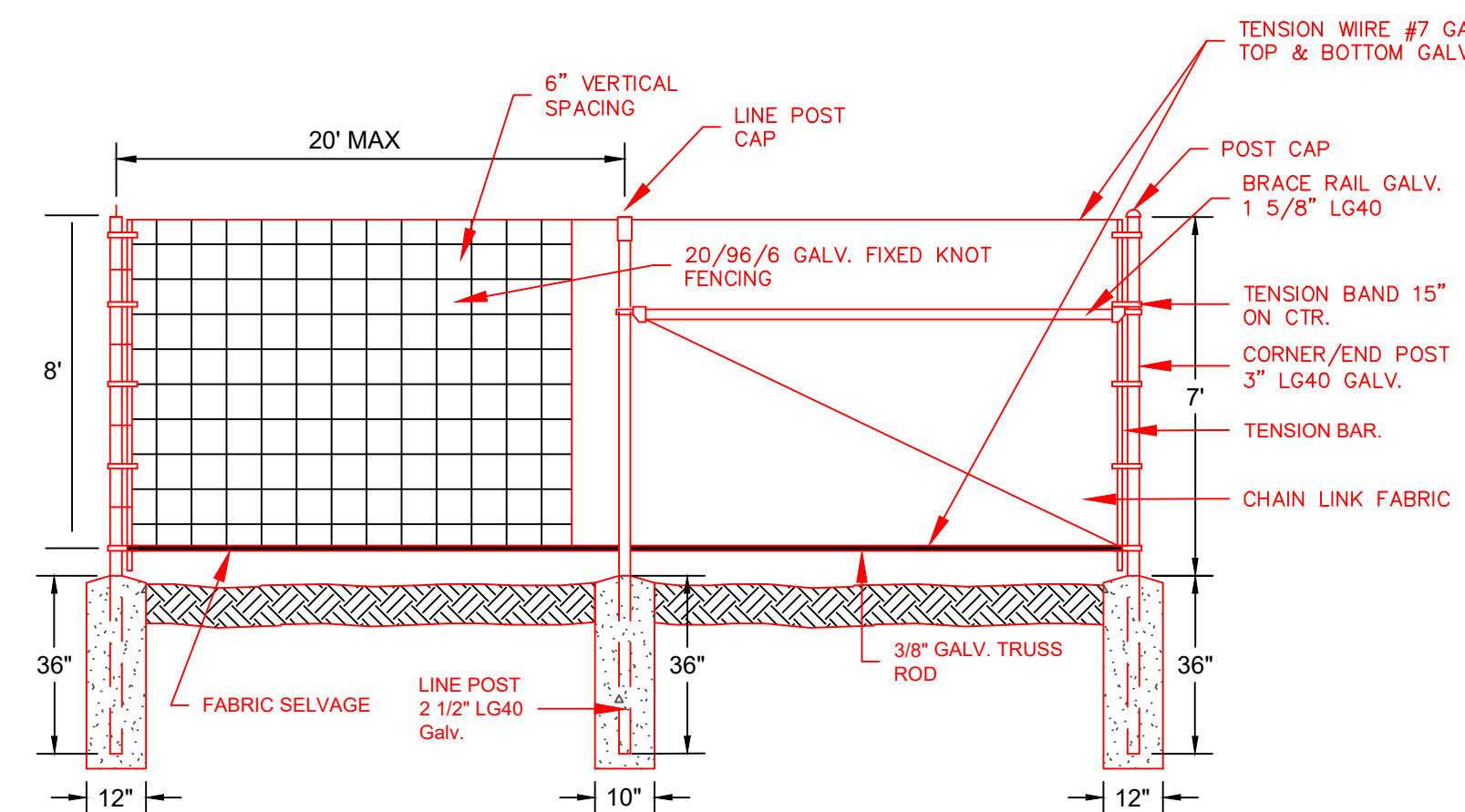

NOTE 14 DETAIL

AN 8 FT WILDLIFE-FRIENDLY SECURITY FENCE WITH A GATE AND LOCKING MECHANISM WILL ENCLOSE THE PERIMETER OF THE SOLAR ARRAY SECTION TO DENY ACCESS TO ANY INDIVIDUALS NOT AUTHORIZED TO BE ON THE PROPERTY AND FOR PUBLIC SAFETY, AS PER SECTION 9-8.6 (J) OF ORDINANCE

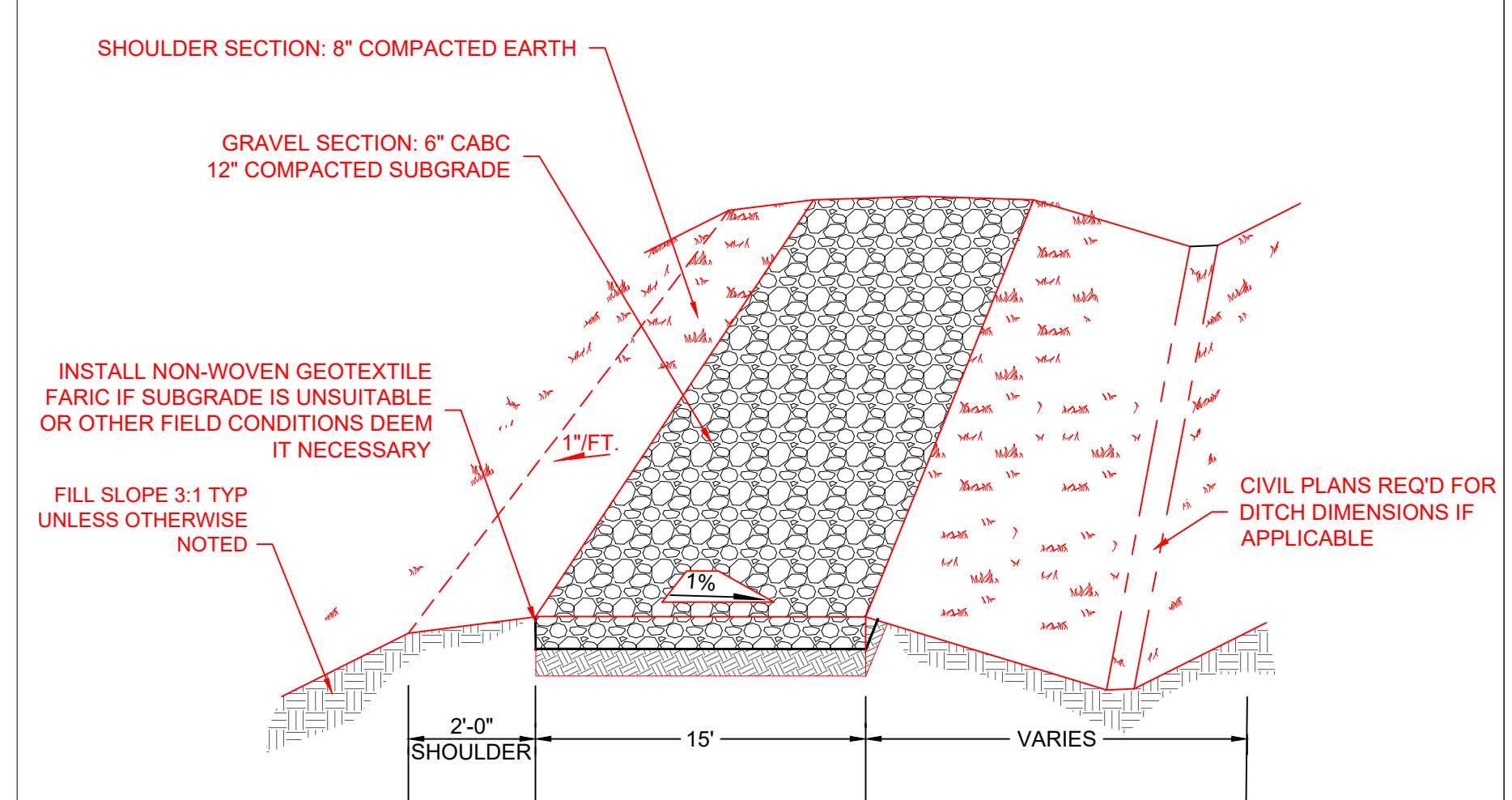

NOTE 15 DETAIL

ALL ACCESS ROADS SHALL COMPLY WITH STANDARD DESIGN PRACTICES AS SHOWN ABOVE. FINAL DESIGN OF ROADWAYS AND ACCESS POINTS ARE SUBJECT TO APPROVAL FROM DOT AND REVIEW FROM BROOKS COUNTY.

SHEET NAME:  
APPENDIX - GENERAL  
NOTES

SHEET NUMBER:  
**APP-100**

THE ENCLOSED CONTENTS ARE INTENDED SOLELY FOR THE ADDRESSEE(S) AND THE INFORMATION THEREIN IS CONSIDERED CONFIDENTIAL. RECIPIENT SHALL NOT COPY, DISCLOSE, OR PERMIT ANY OF ITS EMPLOYEES, AGENTS, OR INDEPENDENT CONTRACTORS TO DISCLOSE THE CONFIDENTIAL INFORMATION TO ANY THIRD PARTIES WITHOUT PINE GATE RENEWABLES, LLC'S PRIOR WRITTEN CONSENT.